



Warlingham School  
& Sixth Form College



# Year 6 Induction

We're looking forward to welcoming you!

Name: \_\_\_\_\_

Tutor Group: \_\_\_\_\_

# CONTENTS

Welcome letter from Mrs MacMahon .....	1
Our Values and Motto .....	2
The School Day and Registration .....	3
Key Dates from the Website .....	4
The School Code .....	5
The House System .....	6
Let's hear from a Year 7 Student .....	7
Starting at Warlingham.....	8
Finding my way around the School .....	9-11
The Warlingham Learner.....	12
The Learning Journey .....	13
Clubs and Activities .....	14
Where do I go for help?.....	15
Finding things out .....	16
My Personal Profile .....	17
Getting to know you .....	18-19
Catering .....	20
Any questions? .....	20
Notes page .....	21



*Please work through this booklet.  
Remember to bring it with you in September,  
to give to your form tutor.*

## WELCOME LETTER



Warlingham School  
& Sixth Form College

Wide Horizons  
High Aspirations

Dear Student

We would like to take this opportunity to welcome you to Warlingham School & Sixth Form College. In September, you will become a fully-fledged Warlingham student; you probably thought that the day would never come! We hope that you are going to enjoy your time with us and that you will take every opportunity to learn, grow and be fully involved in all activities that you are presented with.

On Tuesday 28th and Wednesday 29th June, we would like to invite you to Warlingham to take part in our wonderful induction days. These days will give you an opportunity to experience life as a Warlingham student. You will be involved in a number of fun and exciting activities and will take part in a variety of lessons.

Over the next few weeks, before you join us on the induction days, why not spend some time getting to know what Warlingham is like? We would also love to get to know a little bit about you too. Work through this booklet, trying to answer as much as you can. If you get stuck, have a look at the School website and the Year 7 Handbook.

Your form tutor will look forward to reading these, so please look after them and bring them with you when you start at Warlingham on 5th September!

Good luck and have fun ☺

Mrs MacMahon  
Year 6/7 Transition Co-ordinator

Headteacher: Mr P Foster BA (Hons) MA NPQH FCCT  
Address: Tithepit Shaw Lane, Warlingham, Surrey, CR6 9YB  
Telephone: 01883 624067 Email: info@warlinghamschool.co.uk  
Website: www.warlinghamschool.co.uk

Warlingham School & Sixth Form College is part of the Tandridge Learning Trust, an exempt charity and a company limited by guarantee, registered in England with Company Number 8248059. Registered office: Tithepit Shaw Lane, Warlingham, Surrey, CR6 9YB.

Tandridge Learning Trust

A School within the Tandridge Learning Trust  
VAT No: GB 178 4619 66



## OUR VALUES AND MOTTO



## Wide Horizons High Aspirations

Warlingham School & Sixth Form College is a caring, supportive environment, where children and staff are happy, where we work with integrity and respect, and where everyone is challenged to reach their highest possible achievement.

Our key values are: Courage, Commitment and Kindness.

We take our motto of "Wide Horizons, High Aspirations" very seriously and build in opportunities for our students to develop as individuals through the taught curriculum and an extensive range of additional activities.

What are Warlingham's Key Values? Write them down below:

---

---

---

# THE SCHOOL DAY AND REGISTRATION

## The School Day

Registration	8:35 am
Lesson 1	9:00 am
Lesson 2	10:05 am
<i>Break 11:05 am to 11:20 am</i>	
Lesson 3	11:25 am
Lesson 4	12:30 pm
<i>Lunch 1:30 pm to 2:05 pm</i>	
Lesson 5	2:10 pm
End of the school day / Start of enrichment activities	3:10 pm

## Registration Time

You will see from the section above that you have registration in the morning.



Morning registration begins at 8.35am and ends at 9.00am.

During this time the Form Tutor takes the register and gives out any important information the group needs to know.

During the week, during registration, you will also take part in a variety of activities including: House Assembly, Votes for Schools and equipment checks

## KEY DATES—FROM THE WEBSITE

[www.warlinghamTLT.co.uk](http://www.warlinghamTLT.co.uk)

### AUTUMN TERM 2022

INSET Day (Trust)	1 September 2022
INSET Day	2 September 2022
INSET Day	28 November 2022
Year 7 & Year 12 Staggered Start	5 September 2022
All Other Students Return	6 September 2022
Half Term	24 October - 28 October 2022
Term Ends	16 December 2022 (early closure)

### SPRING TERM 2023

INSET Day	3 January 2023
Students Return	4 January 2023
Half Term	13 February - 17 February 2023
Term Ends	31 March 2023

### SUMMER TERM 2023

INSET Day	3rd July 2023
Students return	17 April 2023
Half Term	29 May - 2 June 2023
Term Ends	21 July 2023 (early closure)

### INSET DAYS

1 September 2022
2 September 2022
28 November 2022
3 January 2023
3 July 2023

Please note, the above dates may be subject to change.



We believe that students, parents, staff, governors and all others within the school community have the responsibility to work together to uphold the Warlingham School Code.

The school code applies to all activities and at any time on the school premises, on school journeys, on the way to and from school and at school events. It helps to maintain a community which is considerate, where interaction is based on mutual respect, and which fosters outstanding learning and teaching.

School Code:

- ✓ To attend school and to be punctual
- ✓ To be properly dressed, equipped and organised for all activities
- ✓ To follow instructions immediately
- ✓ To complete all work to the best of your ability
- ✓ To treat yourself, other people and the environment with respect

To help you be properly equipped, we give you a list of the essential equipment you will need each day.

- Pen – one blue or black pen and one green pen
- Pencil and sharpener
- Colouring pencils
- Ruler
- Rubber
- Calculator (Casio) fx-83/85
- Highlighter

Remember to pack your bag the night before!



## THE HOUSE SYSTEM



At Warlingham School & Sixth Form College, our well-established house system, which was started in 2004, eases your transition. It provides a sense of belonging to a smaller community of the school (approximately 300 students per house) with its own unique ethos and uniform. Siblings join the same house so as to create familiarity for younger brothers and sisters.

Warlingham has four Houses: Chichester, Johnson, Mallory and Sharman. Named after renowned adventurers, each house has its own Head and Deputy Head of House, Form Tutors, support staff and house colour. In Year 7, students are allocated to a form within their house which is overseen by a Form Tutor. This tutor will remain with you throughout your school life. Upon joining their house, students are soon involved in a variety of events and activities during which they can earn House Points, not only for their own benefit but for the benefit of the House too.

The house year culminates in a sporting finale, Sports Day, during which students compete against their competitor houses in a variety of sporting activities. The winning house is awarded the prestigious House Shield which takes pride of place in the Main Reception of the School. Using the school website, name the four Houses and each Head of House:

**Name of House**

**Name of Head of House**

\_\_\_\_\_ House

\_\_\_\_\_

\_\_\_\_\_ House

\_\_\_\_\_

\_\_\_\_\_ House

\_\_\_\_\_

\_\_\_\_\_ House

\_\_\_\_\_

Using our school website, can you find out who your Deputy Head of House and your Form Tutor is?

My Deputy Head of House: \_\_\_\_\_

My Form Tutor: \_\_\_\_\_



## LET'S HEAR FROM A YEAR 7 STUDENT

On my first day at Warlingham, it was nerve wracking, but I was also feeling excited to become an official student at this brilliant school. I felt very smart in my new school uniform – mum is especially pleased that my Kickers have lasted the whole year!

The school has made me become more confident in many subjects and I can definitely say I am a completely different person to who I was at primary school. I am part of Johnson house. Being part of Johnson means I have a form tutor. He is a great teacher and I can't thank him enough for helping me settle into Warlingham.

Warlingham is very different from my primary school and I was nervous about going from being the oldest in school to the youngest again. But lots of teachers helped me find my way around the school and helped me get used to Warlingham. It wasn't just the teachers that helped me, children from all the other years made me feel welcome as well.

I have also liked how I have made new friends from different primary schools. Over the year, my friends have helped me through Year 7 and I know that you will make good friends too because one of our values is kindness and all pupils follow that. I also enjoy school lunches – especially the smoothies! There is always plenty of choice and I enjoy sitting and eating lunch with my friends, inside or outside. I also like that the school has lots of charity activities including bake sales, raffles and multi days.

This year, I am also heading off to the Lake District for Summer Camp. I am looking forward to the trip but at the same time I am a bit nervous about some of the activities, especially abseiling and the long walk I'm participating in. If I didn't go to the Lake District though, I know that I would've missed out on a great experience.

Before I came to Warlingham, I had never done Design Technology but I have made a keyring and a cushion cover all on my own. I am currently working on a handheld game which I will be taking home very soon!

I have beaten my target in many of my subjects, got much better at art and have tried new sports in our PE lessons. In PE, I have tried javelin, discus, cricket, football, gymnastics and lots more. This is one of the reasons why PE is one of my favourite subjects.

I am also proud that I achieved a grade 9 in my art exam and how I have improved lots on my French and Spanish work. I have also had the chance to learn the piano. The teacher was very patient and helpful. You can also get drum, guitar lessons and if you like singing we have singing lessons and our own recording studio.

Overall, Warlingham is a safe and friendly school. It is a good opportunity for you to overcome challenges, make some good friends and try new and exciting subjects.

I am looking forward to Year 8!

# STARTING AT WARLINGHAM



Write a letter to your Form Tutor telling him or her how you feel about starting at Warlingham.

*Try to include what you are looking forward to as well as anything that is worrying you. Also write about what you hope to achieve whilst you are a student here.*

Dear Form Tutor,

---

---

---

---

---

---

---

---

---

---

---

---

---

---

---

---

---

---

---

---

---

---

Yours sincerely,

\_\_\_\_\_ (Your signature)



# FINDING MY WAY AROUND THE SCHOOL

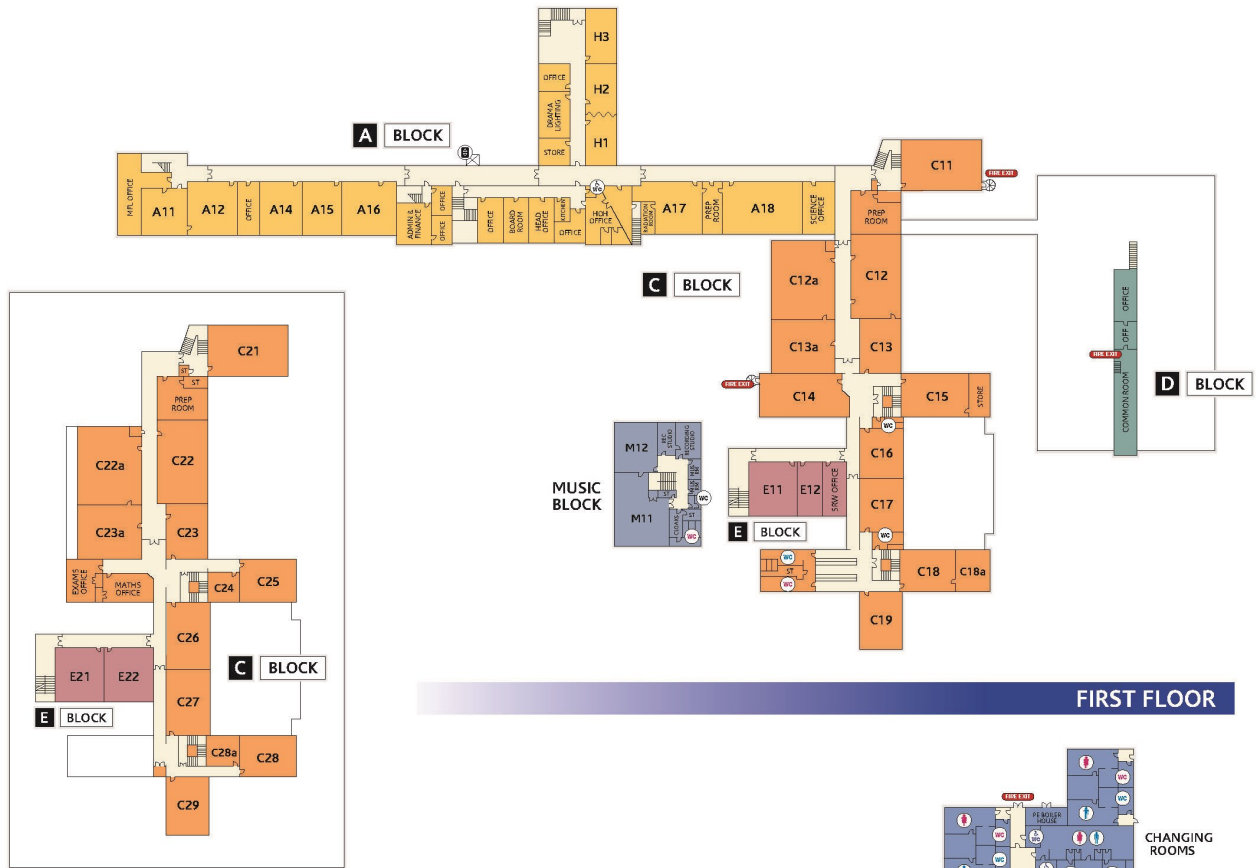

- Lift Disabled Access
- Medical Treatment / Nurses Room
- Disabled Toilet
- Girls Toilet
- Girls Changing
- Boys Toilet
- Boys Changing
- Staff only Toilet



# FINDING MY WAY AROUND THE SCHOOL

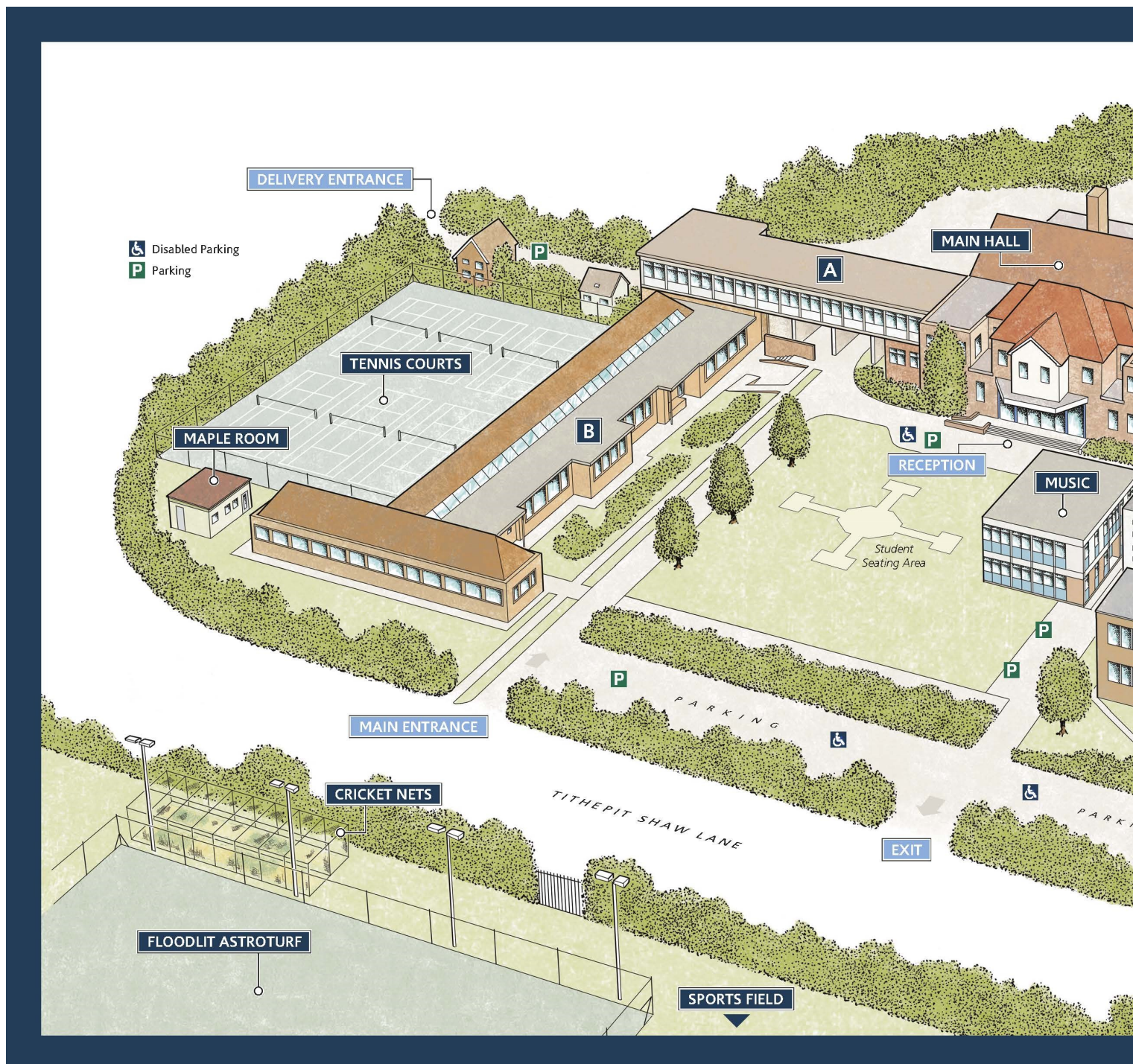

We have some fantastic facilities, name some of them below and on the next page.

Where could you borrow a book? \_\_\_\_\_

Where could you play a sport at night? \_\_\_\_\_

Where might you compose music? \_\_\_\_\_



# FINDING MY WAY AROUND THE SCHOOL

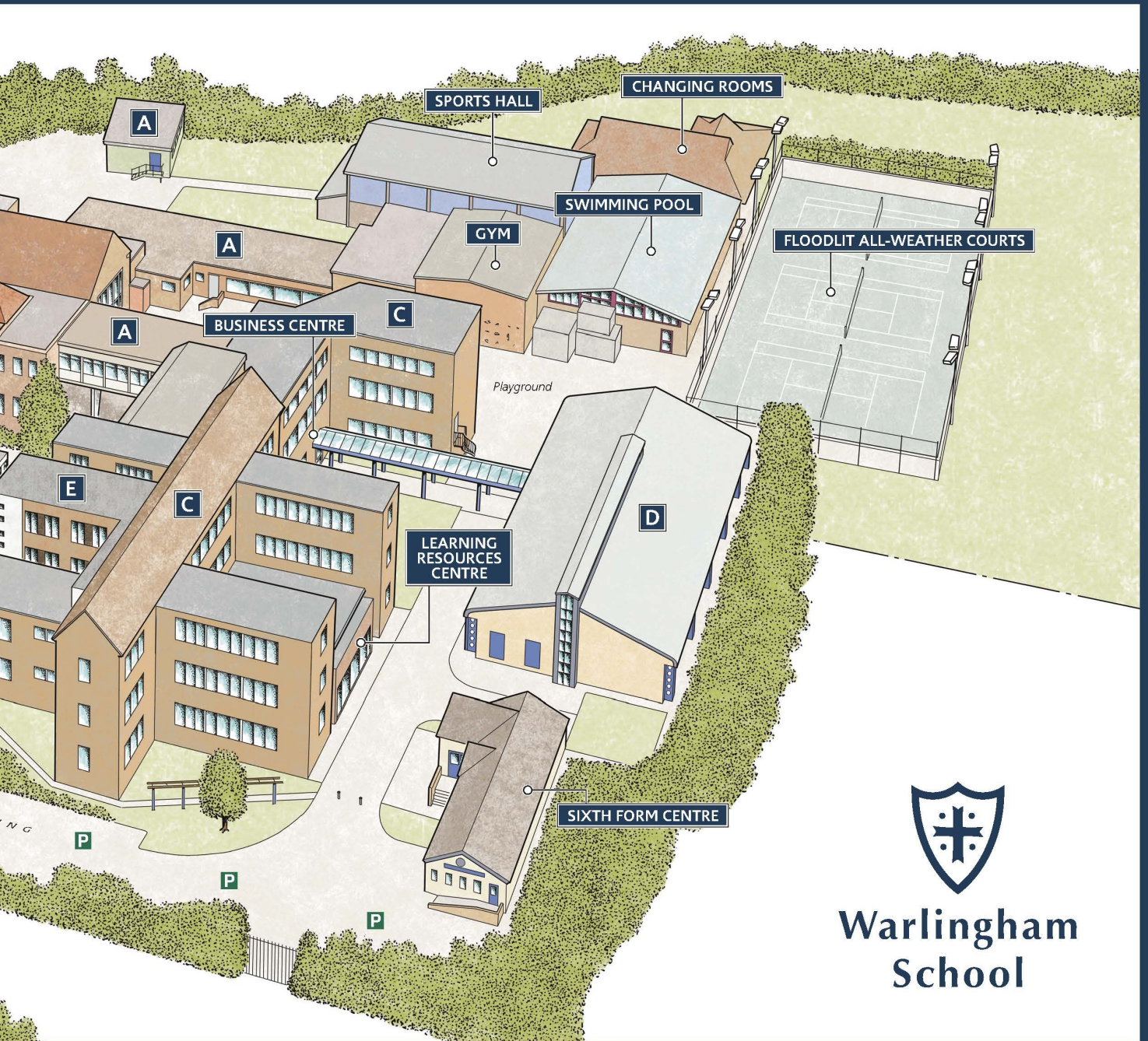

Published by Location Maps Ltd. Tel: 0800 731 4084. www.locationmaps.com. All rights reserved.

Where could you play badminton? \_\_\_\_\_

Where could you do breaststroke? \_\_\_\_\_

Where might you learn about businesses? \_\_\_\_\_

Where might you practice cricket? \_\_\_\_\_

# THE WARLINGHAM LEARNER



Our aim is to develop well-rounded, well-adjusted, successful young people.

The characteristics that we aim to nurture in the Warlingham Learner are based upon our school values of courage, commitment and kindness. We have three values, each of which have three characteristics we wish to develop. This is outlined in the table below.

We seek to develop these characteristics through a mixture of approaches – both subtle and explicit. The characteristics are nurtured through interactions, role modelling, praise, planned learning activities and through the deliberate application and use of language. As a learning community, we all make a commitment to developing outstanding lifelong

learners and we strive to ensure that there are no barriers or excuses to being the best learners we can be.

COURAGE	COMMITMENT	KINDNESS
<p>We are up for a challenge. We are:</p> <ul style="list-style-type: none"> <li>• Adventurous</li> <li>• Motivated</li> <li>• Curious</li> </ul>	<p>We keep going, even when things are hard. We are:</p> <ul style="list-style-type: none"> <li>• Persevering</li> <li>• Willing to make effort</li> <li>• Prepared to delay gratification</li> </ul>	<p>We think of others' feelings before we act. We are:</p> <ul style="list-style-type: none"> <li>• Respectful</li> <li>• Considerate</li> <li>• Empathetic</li> </ul>
<p>We see mistakes as opportunities to learn. We are:</p> <ul style="list-style-type: none"> <li>• Responsible for our actions</li> <li>• Resilient</li> <li>• Determined</li> </ul>	<p>We plan and anticipate. We are:</p> <ul style="list-style-type: none"> <li>• Methodical</li> <li>• Organised</li> <li>• Rigorous</li> </ul>	<p>We celebrate our differences and treat people as equals. We are:</p> <ul style="list-style-type: none"> <li>• Inclusive</li> <li>• Accepting</li> <li>• Open-minded</li> </ul>
<p>We are keen to improve. We are:</p> <ul style="list-style-type: none"> <li>• Reflective</li> <li>• Self-evaluative</li> <li>• Willing to take risks</li> </ul>	<p>We are capable of managing distractions. We are:</p> <ul style="list-style-type: none"> <li>• Focused</li> <li>• Goal-orientated</li> <li>• Tenacious</li> </ul>	<p>We contribute. We are:</p> <ul style="list-style-type: none"> <li>• Keen to volunteer</li> <li>• Proactive citizens</li> <li>• Supportive</li> </ul>

# THE LEARNING JOURNEY

This diagram represents what we expect from students in lessons.



**AM I CLEAR ABOUT THE DESTINATION?**

- I understand what I will need to do at the end of the learning.
- I know which key vocabulary will be used in my answers and how.
- I look at model answers or practices and understand success criteria and mark schemes.
- I make connections with other subjects.

**HAVE I CHECKED MY STARTING POINTS?**

- I know my own needs and how to get the support I need.
- I know what I have achieved so far and what I already know and can do.
- I am always trying to see how close to the destination I am.

**DO I KNOW THE STEPPING STONES I NEED TO TAKE?**

- I set challenging targets that are specific, measurable, achievable, realistic and time-bound and I know what I need to do to meet my targets
- I know how to set new targets when I achieve my current ones.
- My mistakes are opportunities for improvement.

**AM I CHECKING MY ARRIVAL?**

- I check I know by answering questions in class.
- I understand the feedback I am given on what I did well and what can be improved.
- I try to find my own misconceptions and try to repair them.



## CLUBS AND ACTIVITIES

We offer a wide variety of extra curricular clubs at both lunchtime and after-school, including:

- Art
- Athletics
- Badminton
- Chess
- Cricket
- Debate
- Drama
- Drama Tech
- Fitness Suite
- Football
- French Surgery
- German
- Handball
- Hockey
- Home Learning
- Maths Leaders
- Maths TLC
- Music Practice
- Netball
- Orchestra
- Photography & digital illustration
- Rock Club
- Russian Club
- Science club
- Singing
- Swimming: Squad
- Swimming Improver
- Swimming: Lane
- Table Tennis
- Trampolining





## WHERE DO I GO FOR HELP?

We hope you don't have any problems in your time at Warlingham School & Sixth Form College, but just in case you do, the table below shows you where to go to get help.

PROBLEM			
Friendship	Lost property/ Lockers	Lessons/Work/ Home Learning	Behaviour
WHO CAN HELP?			
Tutor ↓ Head of House Deputy Head of House	Tutor ↓ Student Services	Class Teacher ↓ Head of Department ↓ Head of House Deputy Head of House	Tutor ↓ Head of House Deputy Head of House ↓ Senior Manager

Who do you see if you are stuck with your home learning?

---

---

Who do you speak to if you have a friendship issue?

---

---

Who do you speak to if you have lost something?

---

---

## FINDING THINGS OUT...

Try and find out some information about Warlingham School & Sixth Form College. You can use the school website, the Year 7 Handbook and the maps in this booklet to help you to fill in the information below.

Name of the Headteacher: \_\_\_\_\_

Name of the Head of Maths: \_\_\_\_\_

Name of the Head of Science: \_\_\_\_\_

Name of the Head of English: \_\_\_\_\_

What do you do if you arrive at school after registration?

---

---

---

Where is the room, H1?                      Block: \_\_\_\_\_ Floor: \_\_\_\_\_

Where is the Food Tech room?        Block: \_\_\_\_\_ Floor: \_\_\_\_\_

Where is the Dining Hall?                Block: \_\_\_\_\_ Floor: \_\_\_\_\_

Draw a picture of yourself in the frame below.

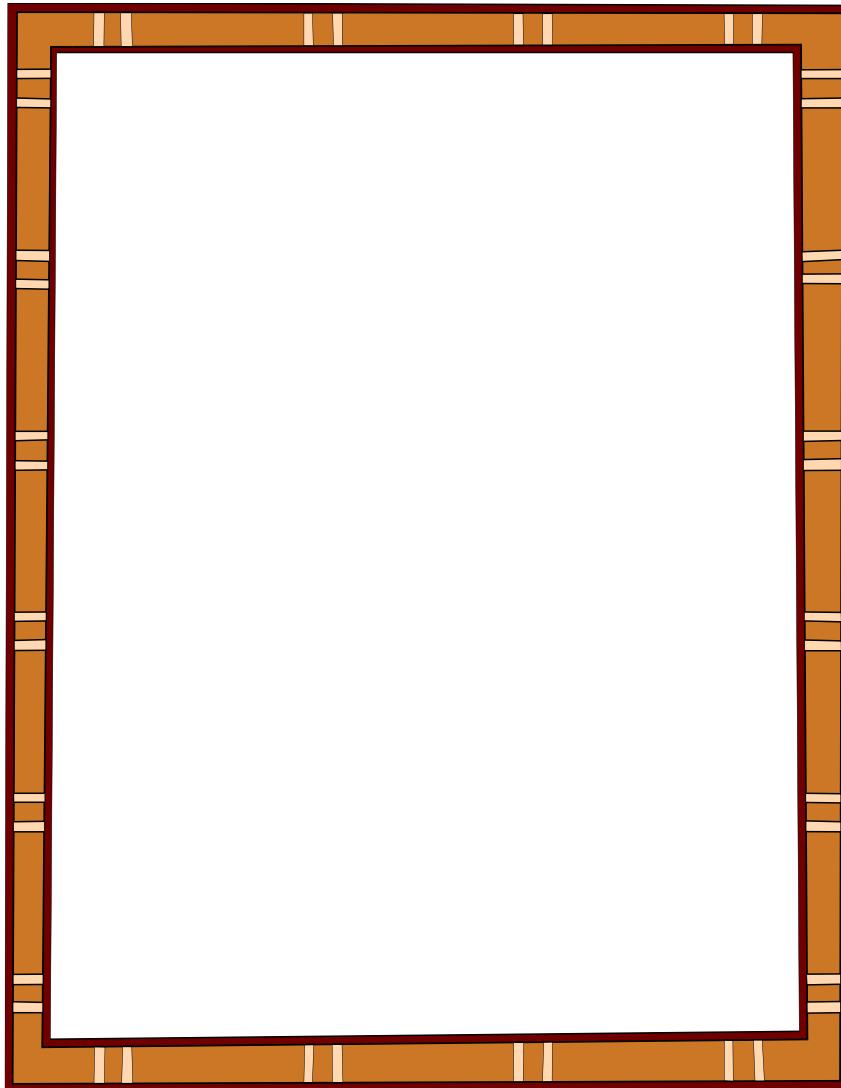

Fill in the gaps below:

Name: \_\_\_\_\_

Address: \_\_\_\_\_  
\_\_\_\_\_

Age: \_\_\_\_\_ Date of Birth: \_\_\_\_\_

Eye Colour: \_\_\_\_\_ Hair Colour: \_\_\_\_\_ Height (in metres): \_\_\_\_\_

No. of brothers & sisters: \_\_\_\_\_ No. of cousins: \_\_\_\_\_

## GETTING TO KNOW YOU

Your Form Tutor will want to know all about you. Fill in these boxes to help him or her.

These are a few of my favourite things...

Colour:

Drink:

Food:

Hobby:

Pet:

Band:

Sport:

TV Programme:



Things that make me go BOO!

Fill in the shapes below with everything you dislike...

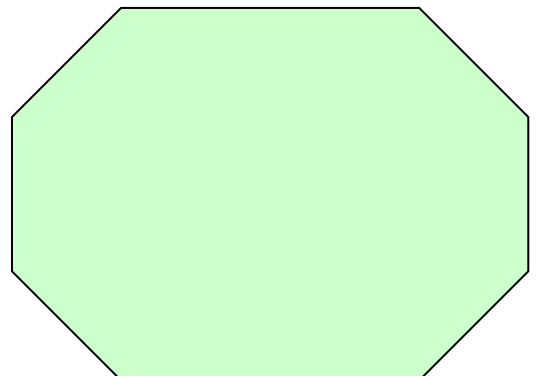
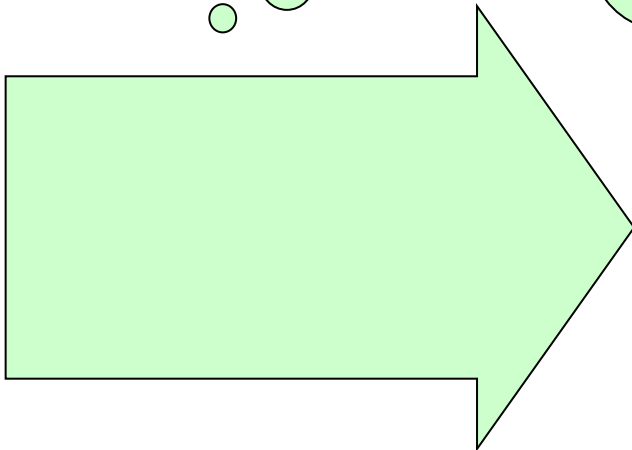
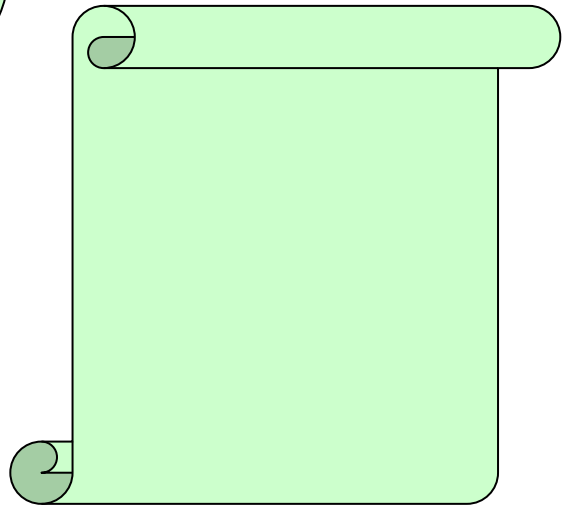
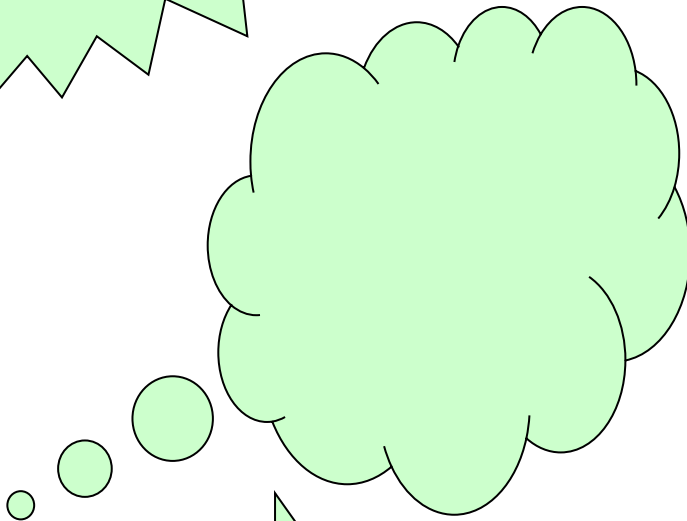
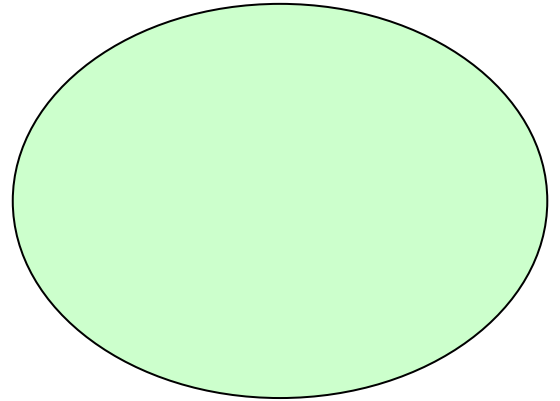
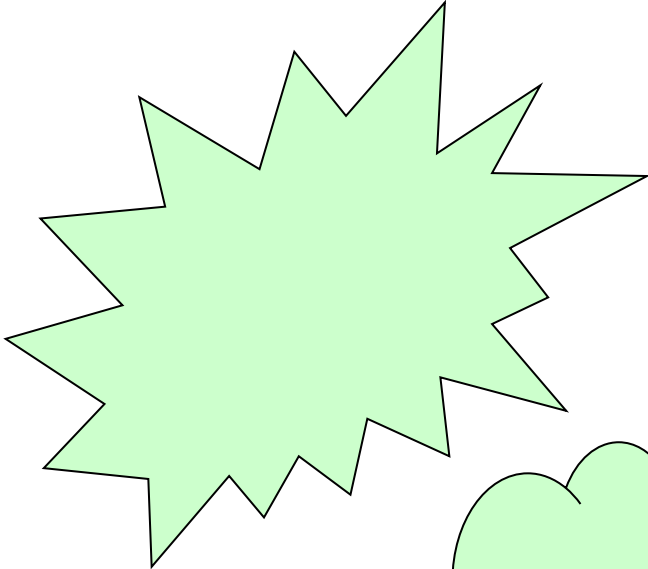

## CATERING

We have a contract with a company called *Twelve15* to provide our school meals service. The canteen is open at break time, lunchtime and at certain times during the year, before school.

A variety of food is available each day ranging from sandwiches and wraps, to pasta and curry dishes, salad pots, paninis, fruit, cakes and biscuits plus a selection of healthy drinks. A 'main meal' of the day is always available at lunchtime.

Food is cooked on the school premises and meets current school meal regulations with particular care taken regarding fat, salt and sugar content. In December 2021, our canteen achieved the highest rating (5) for Food Safety & Hygiene by Tandridge District Council.

Nuts may be present in food preparation areas so people with a nut allergy should consult the Head of Catering, Mrs Rowell.

Food is purchased via a fingerprint recognition system through "WisePay". See our website for further information.



## ANY QUESTIONS?

If you have any questions about joining Warlingham School & Sixth Form College, or any general questions about secondary school life, I would be very happy to help you.

Please ask your parent / carer to email me your question(s): [D.Macmahon@WarlinghamTLT.co.uk](mailto:D.Macmahon@WarlinghamTLT.co.uk). Please do not email me directly from your own email account.

I look forward to answering any questions you may have and to meeting you very soon.

A handwritten signature in black ink that reads "D MacMahon".

Mrs MacMahon  
Year 6/7 Transition Co-ordinator



Use this page to make your own notes.

---

---

---

---

---

---

---

---

---

---

---

---

---

---

---

---

---

---

---

---

---

---

---

---



# Warlingham School & Sixth Form College

Tandridge Learning Trust trading as Warlingham School & Sixth Form College  
Tithepit Shaw Lane, Warlingham, Surrey, CR6 9YB

Website: [www.WarlinghamTLT.co.uk](http://www.WarlinghamTLT.co.uk)  
Phone: 01883 624067      E-mail: [Info@WarlinghamTLT.co.uk](mailto:Info@WarlinghamTLT.co.uk)